

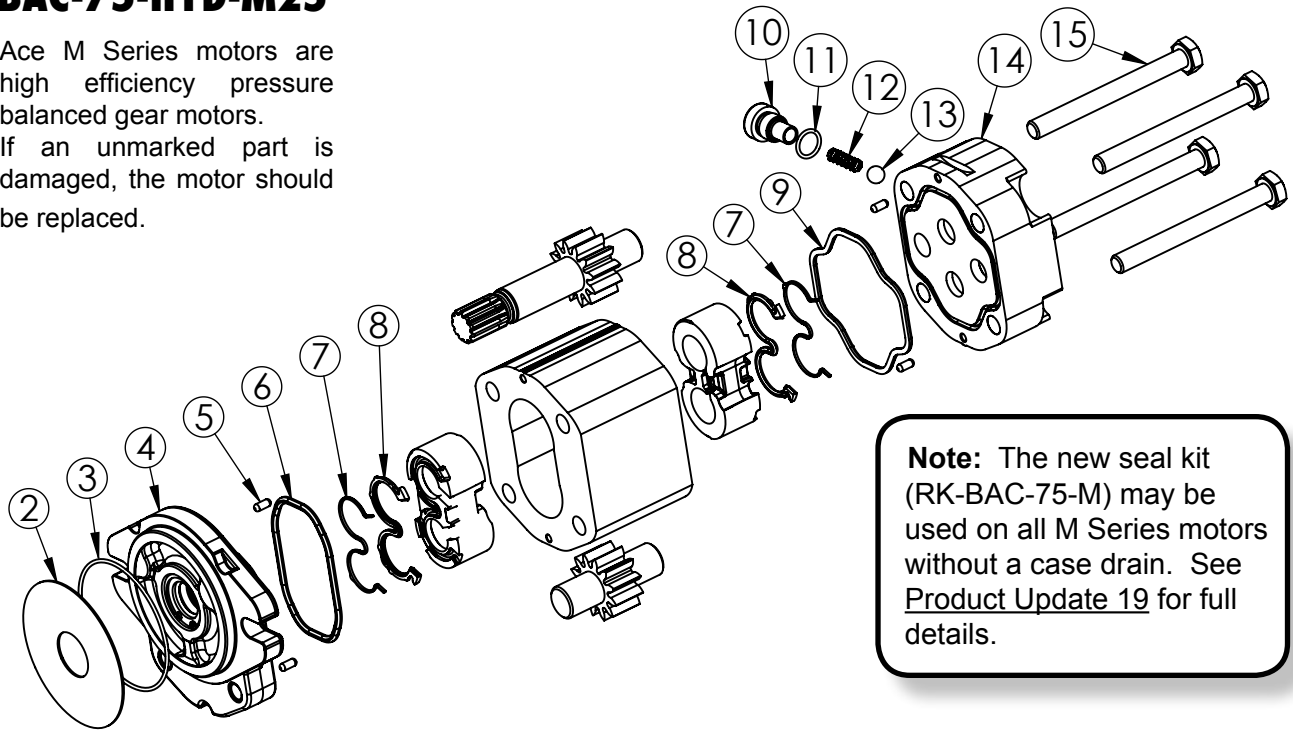

HYDRAULIC MOTOR PARTS LIST

BAC-75-HYD-M16 BAC-75-HYD-M22 BAC-75-HYD-M25

Ace M Series motors are high efficiency pressure balanced gear motors. If an unmarked part is damaged, the motor should be replaced.



Note: The new seal kit (RK-BAC-75-M) may be used on all M Series motors without a case drain. See [Product Update 19](#) for full details.

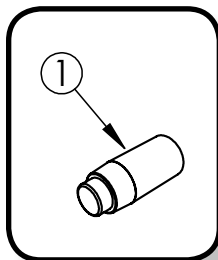

Important: The seal installation tool ① is required to install the shaft seal. This tool is included with the repair kit RK-BAC-75-M (40138). It prevents damage to the seal lips during installation over the splined shaft.

REF #	M16	M22	M25	DESCRIPTION	REQ.
1 ^①	43416	43416	43416	Installation tool, shaft seal	1
2 ^①	43414	43414	43414	Absorbent pad	1
3 ^①	43419	43419	43419	O-ring, flange	1
4 ^①	43418	43418	43418	Drive plate assembly, flange, M motors, Eff. 6/15	1
5	43420	43420	43420	Pin, motor assembly	4
6	43425	43425	43425	Housing seal, front external	1
7	43430	43430	43430	Anti-extrusion seal, M motors	2
8	43435	43435	43435	Compensation seal, M motors	2
9	43440	43440	43440	Housing seal, rear external	1
10	43445	43445	43445	Cap, coasting check	1
11	43450	43450	43450	O-ring, coasting check cap	1
12	43455	43455	43455	Spring, coasting check	1
13	43460	43460	43460	Ball, coasting check	1
14	43465	43465	43465	End plate, cover, #10 SAE end ports	1
15	43470	43475	43475	Cap screw, motor assembly, hex head	4
①	40138	40138	40138	RK-BAC-75-M, repair kit includes 1, 2, 3, & 4	--



HYDRAULIC MOTOR PARTS LIST

- BAC-75-HYD-M16-CD**
- BAC-75-HYD-M16-CDE***
- BAC-75-HYD-M22-CD**
- BAC-75-HYD-M25-CD**
- BAC-75-HYD-M30-CD***

* These motors have all ports on the end plate. All other models have side ports on the gear housing and the case drain port on the end plate.

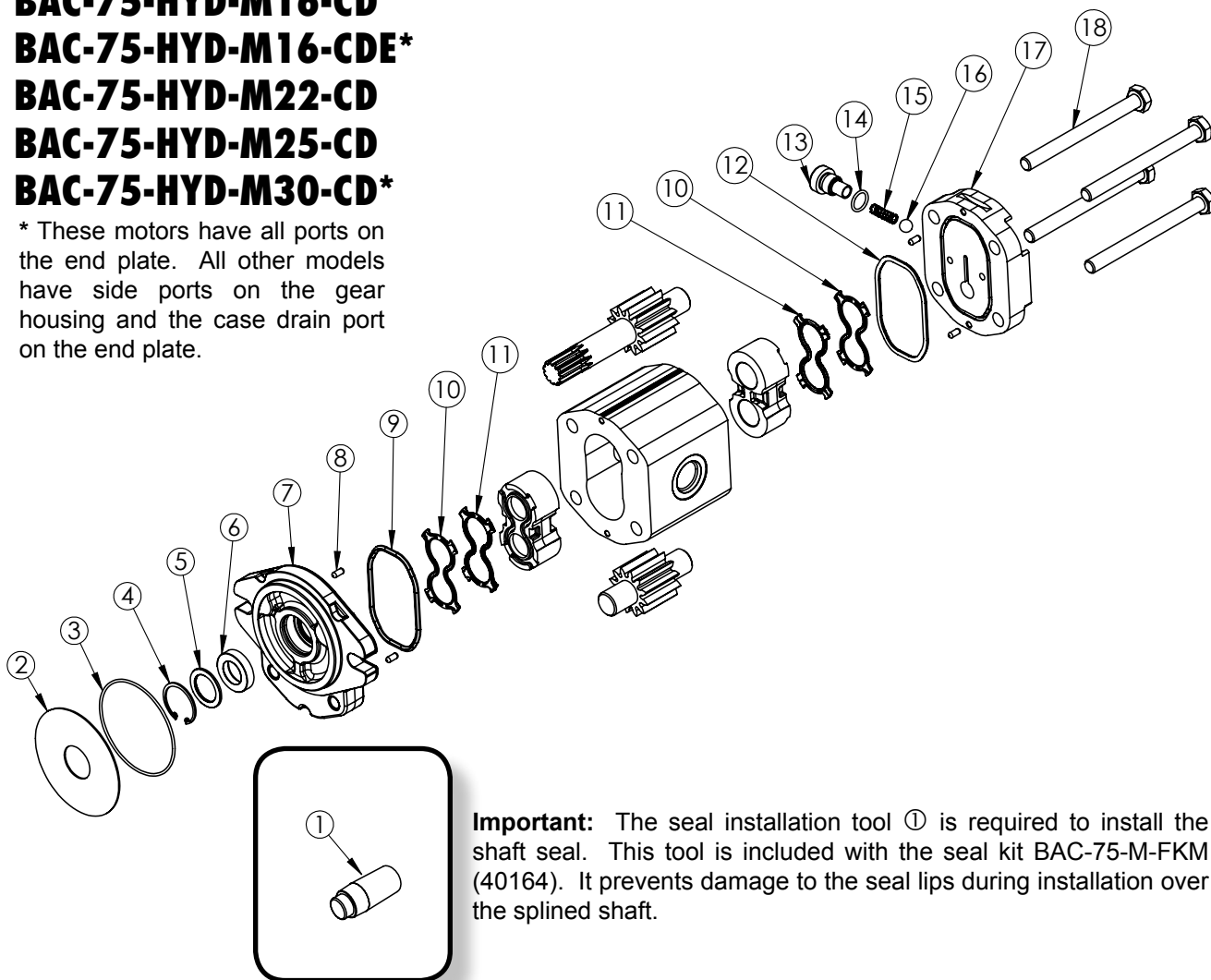

Important: The seal installation tool ① is required to install the shaft seal. This tool is included with the seal kit BAC-75-M-FKM (40164). It prevents damage to the seal lips during installation over the splined shaft.

REF #	M16-CD	M16-CDE	M22-CD	M25-CD	M30-CD	DESCRIPTION	REQ.
1 ^①	43416	43416	43416	43416	43416	Installation tool, shaft seal	1
2 ^①	43414	43414	43414	43414	43414	Absorbent pad	1
3 ^①	43419	43419	43419	43419	43419	O-ring, flange	1
4	43400	43400	43400	43400	43400	Snap ring, shaft seal retainer	1
5	43407	43407	43407	43407	43407	Spacer ring, shaft seal, M-CD motors	1
6 ^①	43411	43411	43411	43411	43411	Shaft seal, Viton, M-CD motors	1
7	43417	43417	43417	43417	43417	Drive plate, flange, M-CD motors	1
8	43420	43420	43420	43420	43420	Pin, motor assembly	4
9	43425	43425	43425	43425	43425	Housing seal, front external	1
10	43431	43431	43431	43431	43431	Anti-extrusion seal, M-CD motors	2
11	43436	43436	43436	43436	43436	Compensation seal, M-CD motors	2
12	43425	43440	43425	43440	43440	Housing seal, rear external	1
13	43445	43445	43445	43445	43445	Cap, coasting check	1
14	43450	43450	43450	43450	43450	O-ring, coasting check cap	1
15	43455	43455	43455	43455	43455	Spring, coasting check	1
16	43460	43460	43460	43460	43460	Ball, coasting check	1
17	43467	43466	43467	43466	43466	End plate, cover, #6 case drain port	1
18	43470	43472	43475	43480	43480	Cap screw, motor assembly, hex head	4
①	40164	40164	40164	40164	40164	BAC-75-M-FKM, Shaft seal kit includes items 1- 4	--